

W6010 TANK SPECIFICATIONS

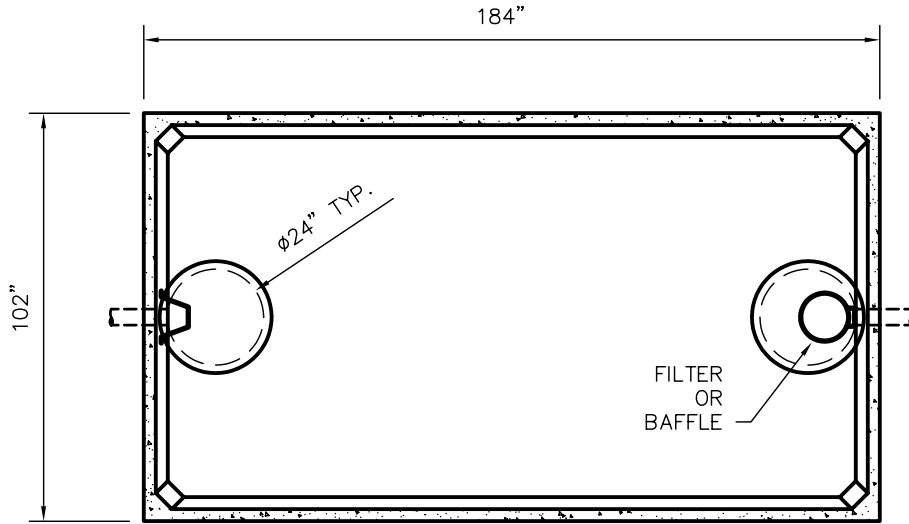

TOP VIEW

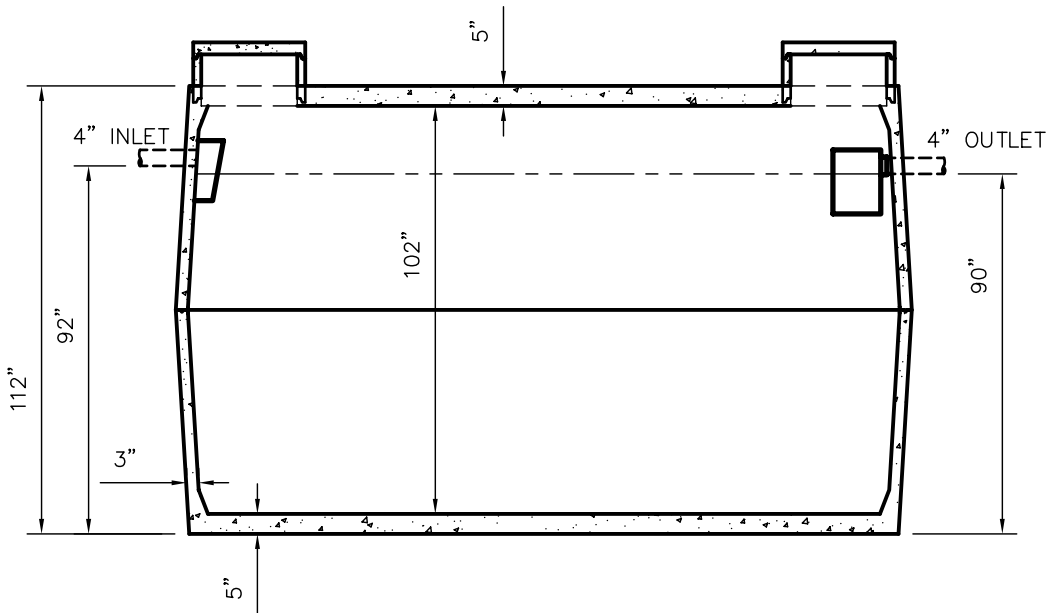

SIDE VIEW

DIMENSIONS:

- WALL: 3"
- BOTTOM: 5"
- COVER: 5"
- MANHOLE: 24" I.D. PRECAST CONCRETE RISER
- HEIGHT: 112" O.D.
- LENGTH: 184" O.D.
- WIDTH: 102" O.D.
- BELOW INLET: 92" O.D.
- LIQUID LEVEL: 85"
- WEIGHT: 15,050 LBS. PER SECTION

INLET AND OUTLET:

- 4" CAST-A-SEAL BOOT OR EQUAL GASKET, CAST-A-SEAL BOOT OR EQUAL

INLET AND OUTLET BAFFLE AND FILTER:

- WISCONSIN, SEE DETAIL #10 (OTHER STATES SEE CHART)

LIQUID CAPACITY: 70.71 GAL/IN

LOADING DESIGN: 8' 0" UNSATURATED SOIL

TANK CAN BE USED AS:

- SEPTIC/ HOLDING/ PUMP OR SIPHON

HOLDING TANK:

- OUTLET HOLE PLUGGED
- ACTUAL CAPACITY: 6,152 GALLONS

CUSTOMIZED TANKS:

TANKS CAN BE CUSTOMIZED CONTACT WESER CONCRETE

TANKS ARE MANUFACTURED TO MEET OR EXCEED ASTM C-1227 REQUIREMENTS

SCALE: 1/4" = 1'	REV NO.	DATE:	
DRAWN BY: SWT			
DATE: JANUARY 2008			
FILE: W6010			
WESER CONCRETE			
W3716 US HWY10, MAIDEN ROCK, WI 54750			
800-325-8456			
W6010	SEPTIC MANUAL		
	REV. JAN. 2008		
SHEET NO.		OF	
0		0	