

# WLP1585 950 TANK SPECIFICATIONS

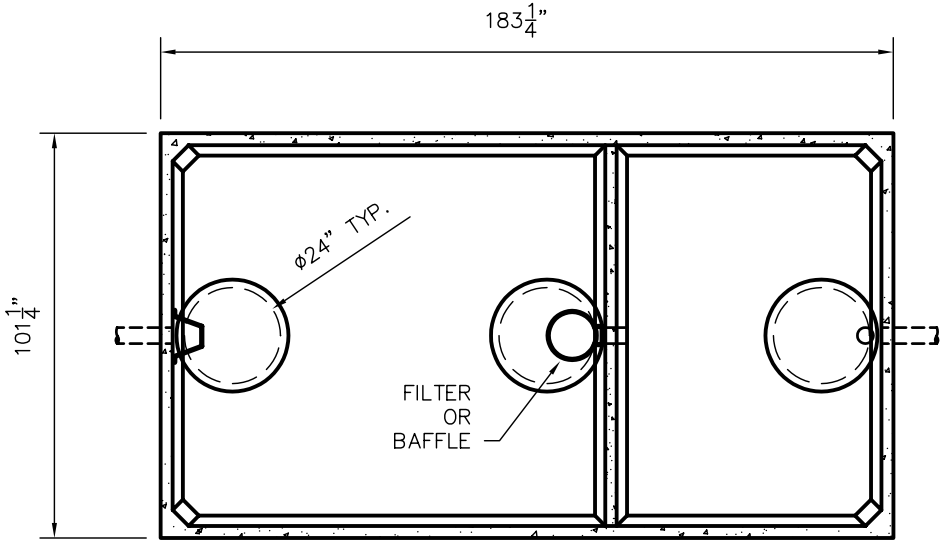

TOP VIEW

**DIMENSIONS:**  
 WALL: 3"  
 BOTTOM: 3"  
 COVER: 6"  
 MANHOLE: 24" I.D. PRECAST CONCRETE RISER  
 HEIGHT: 53 3/4" O.D.  
 LENGTH: 183 1/4" O.D.  
 WIDTH: 101 1/4" O.D.  
 BELOW INLET: 43" O.D.  
 LIQUID LEVEL: 38"  
 WEIGHT: TANK 13,010 LBS.  
 WEIGHT: COVER 9,300 LBS.

**INLET AND OUTLET:**  
 4" CAST-A-SEAL BOOT OR EQUAL  
 GASKET, CAST-A-SEAL BOOT OR EQUAL  
**INLET AND OUTLET BAFFLE AND FILTER:**  
 WISCONSIN, SEE DETAIL #10  
 (OTHER STATES SEE CHART)

**LIQUID CAPACITY:** 41.67 GAL/IN (SEPTIC)  
 25.00 GAL/IN (PUMP)

**LOADING DESIGN:** 8' 0" UNSATURATED SOIL

TANK CAN BE USED AS:  
 SEPTIC/ HOLDING/ PUMP OR SIPHON  
 OR SEPTIC/SIPHON

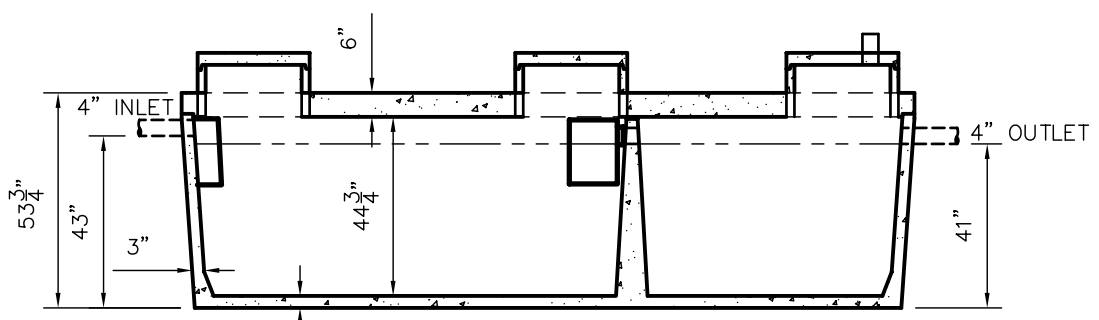

SIDE VIEW

CUSTOMIZED TANKS:  
 TANKS CAN BE CUSTOMIZED CONTACT WIESER CONCRETE  
 TANKS ARE MANUFACTURED TO MEET OR EXCEED ASTM C-1227 REQUIREMENTS

SCALE: 1/4" = 1'	REV NO.	DATE:	
DRAWN BY: SWT			
DATE: JANUARY 2008			
FILE: WLP1585 950			
<b>WIESER CONCRETE</b>			
W3716 US HWY10, MAIDEN ROCK, WI 54750			
800-325-8456			
WLP1585 950	SEPTIC MANUAL		
	REV. JAN. 2008		
SHEET NO.			
0 OF 0			