

# WLP1250-P TANK SPECIFICATIONS

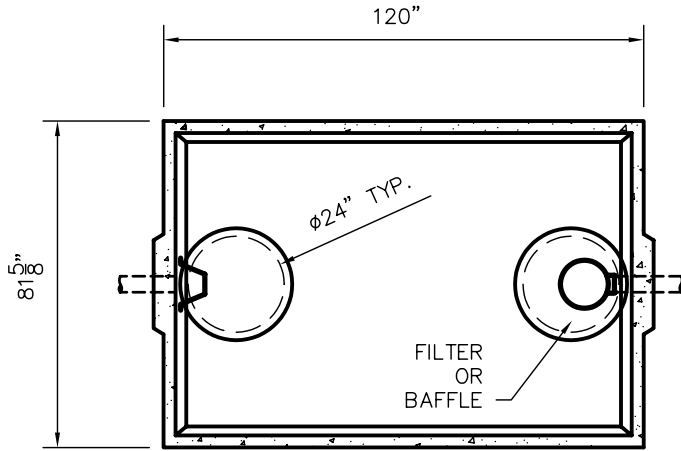

TOP VIEW

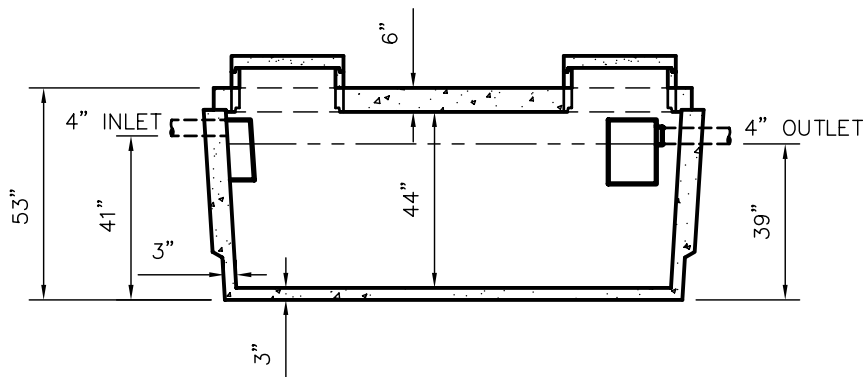

SIDE VIEW

**DIMENSIONS:**

- WALL: 3"
- BOTTOM: 3"
- COVER: 6"
- MANHOLE: 24" I.D. PRECAST CONCRETE RISER
- HEIGHT: 53" O.D.
- LENGTH: 120" O.D.
- WIDTH: 81 5/8" O.D.
- BELOW INLET: 41" O.D.
- LIQUID LEVEL: 36"
- WEIGHT: 11,888 LBS.

**INLET AND OUTLET:**

- 4" CAST-A-SEAL BOOT OR EQUAL
- GASKET, CAST-A-SEAL BOOT OR EQUAL

**INLET AND OUTLET BAFFLE AND FILTER:**

- WISCONSIN, SEE DETAIL #10

LIQUID CAPACITY: 34.98 GAL/IN

LOADING DESIGN: 8' 0" UNSATURATED SOIL

**HOLDING TANK:**

- OUTLET HOLE PLUGGED
- ACTUAL CAPACITY: 1,435 GALLONS

**TANK CAN BE USED AS:**

- SEPTIC/ HOLDING/ PUMP OR SIPHON

CUSTOMIZED TANKS:  
TANKS CAN BE CUSTOMIZED CONTACT WIESER CONCRETE  
TANKS ARE MANUFACTURED TO MEET OR EXCEED ASTM C-1227 REQUIREMENTS

SCALE: 1/4" = 1'	REV NO.	DATE:	
DRAWN BY: SWT			
DATE: JANUARY 2008			
<b>WIESER CONCRETE</b>		800-325-8456	
W3716 US HWY10, MAIDEN ROCK, WI 54750		FILE: WLP1250-P	
WLP1250-P	SEPTIC MANUAL		
REV. JAN. 2008			
SHEET NO.		0 OF 0	