

W1000 600-MR TANK SPECIFICATIONS

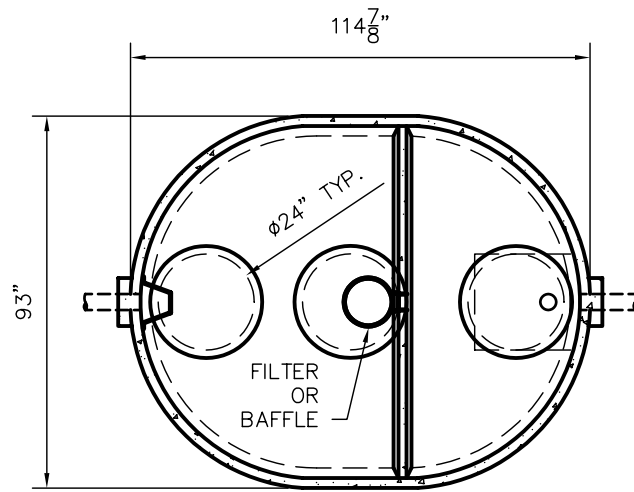

TOP VIEW

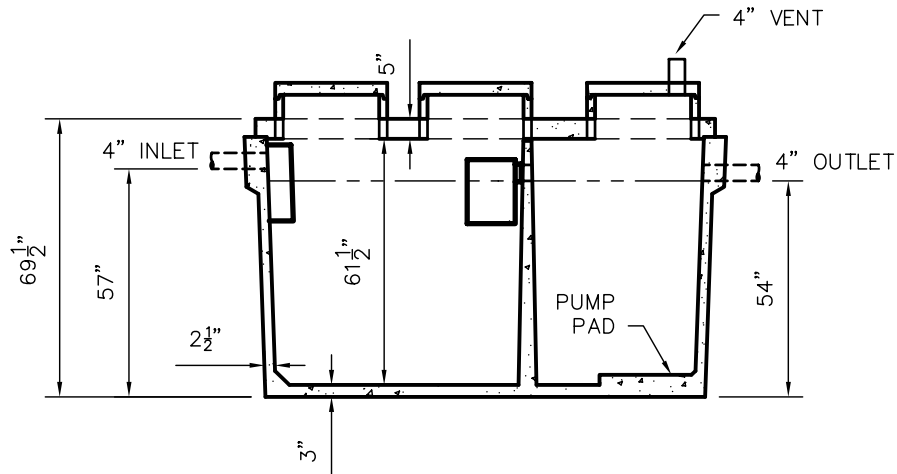

SIDE VIEW

DIMENSIONS:

- WALL: 2 1/2"
- BOTTOM: 3"
- COVER: 5"
- MANHOLE: 24" I.D. PRECAST CONCRETE RISER
- HEIGHT: 65" O.D.
- LENGTH: 114 7/8" O.D.
- WIDTH: 93" O.D.
- BELOW INLET: 57" O.D.
- LIQUID LEVEL: 51"
- WEIGHT: 12,380 LBS.

INLET AND OUTLET:

- 4" CAST-A-SEAL BOOT OR EQUAL
- GASKET, CAST-A-SEAL BOOT OR EQUAL

INLET AND OUTLET BAFFLE AND FILTER:

- WISCONSIN, SEE DETAIL #10
- (OTHER STATES SEE CHART)

- LIQUID CAPACITY: 19.61 GAL/IN (SEPTIC)
- 11.82 GAL/IN (PUMP)

LOADING DESIGN: 8' 0" UNSATURATED SOIL

MN TANKS:

- WILL HAVE ONE VENT OVER OUTLET
- AND WILL HAVE TWO VENTS IN COVER OVER INLET

TANK CAN BE USED AS:

- SEPTIC/SEPTIC, SEPTIC/PUMP
- OR SEPTIC/SIPHON

CUSTOMIZED TANKS:

TANKS CAN BE CUSTOMIZED CONTACT WIESER CONCRETE

TANKS ARE MANUFACTURED TO MEET OR EXCEED ASTM C-1227 REQUIREMENTS

| | | |
|---------------------------------------|----------------|-------|
| SCALE: 1/4" = 1' | REV NO. | DATE: |
| DRAWN BY: SWT | | |
| DATE: JANUARY 2008 | | |
| FILE: W1000 600-MR | | |
| WIESER CONCRETE | | |
| W3716 US HWY10. MAIDEN ROCK, WI 54750 | | |
| 800-325-8456 | | |
| W1000 600-MR | SEPTIC MANUAL | |
| | REV. JAN. 2008 | |
| SHEET NO. | 0 OF 0 | |